

# City of Capitola

## Art & Cultural Commission

### Tuesday, February 11, 2025 – 6:30 PM

Council Chambers  
420 Capitola Avenue, Capitola CA 95010

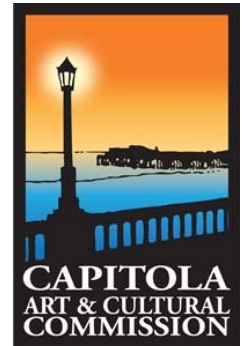

**Chair:** Mary Beth Cahalen

**Vice Chair:** Roy Johnson

**Commissioners:** Karin Anderson, Courtney Christiansen, Joe Clarke, Laurie Hill, Roy Holmberg, Jill Lengre, Esther Sylvan,

**Staff Representatives:** Nikki Bryant

- 
1. **Call to Order**
  2. **Swearing in New Commissioners**
  3. **Additional Materials**
  4. **Public Oral Communication:** *Public Oral Communication allows members of the public to address the Commission on any Program Report or topics within the purview of the Commission not on the General Business agenda.*
  5. **Commissioner Comments**
  6. **Staff Comments**
  7. **Approval of Minutes- Regular Meeting January 21, 2024**
  8. **Program/Committee Reports:** *All items listed in program and committee reports are staff or committee updates. Public Communication for these items is to be addressed during Public Oral Communication.*
  9. **General Business:** *All items listed in General Business are intended to provide an opportunity for public discussion. The following procedure pertains to each General Business item 1) Staff explanation; 2) Commission Questions; 3) Public Comment; 4) Commission deliberation; 5) Decision.*
    - a. **Commissioner Training:** *Receive training on ethics, transparency, and general governance from the City Attorney's Office and the City Clerk.*
    - b. **National Endowment for the Arts FY26 Grants:** *Provide feedback to staff on the proposed application for the National Endowment for the Arts (NEA) FY26 Grants for Arts Projects (GAP) program. Staff is seeking input on a refined project scope focusing on the mosaic installation at the Rispin Mansion Fountain.*
    - c. **Begonia Festival Commemorative Public Art:** *Provide final feedback for Begonia Festival Commemorative Public Art Dedication Event.*
  10. **Future Agenda Items**
    - a. **Commission Retreat/Goal Setting**
  11. **Adjournment**

Agenda and agenda Packet Materials: The Art and Cultural Commission Agenda is available on the City's website: [www.cityofcapitola.org](http://www.cityofcapitola.org) on Friday prior to the Tuesday meeting. If you need additional information, please contact the City Hall Department at (831) 475-7300

American with Disabilities Act: Disability-related aids or services are available to enable persons with a disability to participate in this meeting consistent with the Federal Americans with Disabilities Act of 1990. Assisted listening devices are available for individual with

*hearing impairments at the meeting in the City Council Chambers. Should you require special accommodation to participate in the meeting due to a disability, please contact the City Clerk's office at least 24-hours in advance of the meeting at (831) 475-7300. In an effort to accommodate individuals with environmental sensitivities, attendees are requested to refrain from wearing perfumes and other scented products.*

*Appeals: Any person who believes that a final action of this advisory body has been taken in error may appeal that decision to the City Council. Appeals must be in writing and delivered to the City Clerk's Office within ten (10) working days from the time of the board's decision. The notice of appeal shall set forth appellant's name, phone number, address to which notices may be sent to the appellant, and the grounds upon which the appeal is made.*

# City of Capitola

## Art & Cultural Commission: Draft Minutes

### Tuesday, January 21, 2025 – 6:30 PM

Council Chambers  
420 Capitola Avenue, Capitola CA 95010

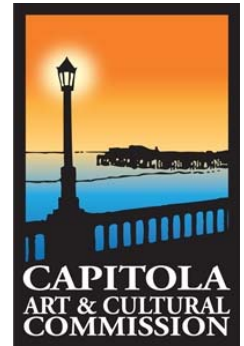

**Chair:** Roy Johnson

**Vice Chair:** Laurie Hill

**Commissioners:** Mary Beth Cahalen, Joe Clarke, Roy Holmberg, Jill Lengre, Esther Sylvan, Vacant At-Large, Vacant Planning Commissioner

**Staff Representatives:** Nikki Bryant

---

#### 1. **Call to Order:**

The meeting was called to order at 6:32PM. In attendance: Cahalen, Clarke, Hill, Holmberg, Lengre, Sylvan, Johnson

#### 2. **Swearing in of New Commissioners**

Commissioner Holmberg, Lengre, Sylvan recited the Oath of Office

#### 3. **Additional Materials**

None

#### 4. **Public Oral Communication**

None

#### 5. **Commissioner Comments**

None

#### 6. **Staff Comments**

January 30<sup>th</sup> City Council meeting and final appointment of At Large Commissioner & Planning Commissioner appointment on Wednesday.

#### 7. **Approval of Minutes- December 16, 2024**

Motion to approve the Minutes: Vice Mayor Clarke

Second: Commissioner Cahalen

Voting Yea: Commissioner Cahalen, Vice Mayor Clarke, Vice Chair Hill, Commissioner Holmberg, Commissioner Lengre, Commissioner Sylvan, Chair Johnson.

#### 8. **Program Reports**

a. **Twilight Concerts:** No Report

b. **Art at the Beach:** No Report

c. **Movies at the Beach:** No Report

d. **Plein Air:** No Report

#### 9. **General Business**

##### a. **Selection of Officers**

Report given by Staff. Vice Mayor Clarke nominated Vice Chair Hill to serve as Chair and Commissioner Cahalen to serve as Vice Chair. Vice Chair Hill declined. Chair Johnson nominated himself to continue as Chair and Commissioner Holmberg to serve as Vice Chair. Commissioner Holmberg declined. Vice Mayor Clarke Nominated Commissioner Cahalen to serve as Chair and Chair Johnson to serve as Vice Chair.

Public Comment:

Motion to approve Commissioner Cahalen to serve as Chair and Commissioner Johnson to serve as Vice Chair for a one-year term ending December 31, 2025: Vice Mayor Clarke

Second: Commissioner Lengre

Voting Yea: Commissioner Cahalen, Vice Mayor Clarke, Vice Chair Hill, Commissioner Holmberg, Commissioner Lengre, Commissioner Sylvan, Chair Johnson.

**b. Selection of Committees**

Report given by Staff. Chair Cahalen commented on past actions of the movie committee. The Commission discussed alternative movie selection processes. Chair Cahalen and Commissioner Lengre expressed interest in being involved in Movie Selections. An ad hoc committee established to assist Staff with the review of Movies to be brought for the Commission. The Commission discussed the Twilight Concerts Committee. Chair Cahalen nominated James Wallace as public member. Commissioner Sylvan, Vice Chair Johnson and Commissioner Lengre volunteered to sit on the committee. Commissioner Hill requested the Plein Air debrief be completed before the selection of committee members. The Commission discussed a Volunteer Recruitment Committee and Vice Mayor Clarke and Chair Cahalen. Vice Mayor Clarke commented on having onboarding requirement and roles for committee members. Staff to provide. The Commission discussed a Sponsorship Recruitment Committee. Commissioner Lengre requested more information regarding Sponsorship Goals. The Commission decided to consider after the retreat. Status Quo for Public Art Committees. The Commission discussed the Banner Project Committee. Decided to Discontinue the committee but agendaize for a future meeting. The Commission discussed discontinuing the Art at the Beach Committee.

Public Comment:

Motion to approve continuing The Begonia Festival Commemorative Public Art Committee with Commissioner Hill, Chair Cahalen, Vice Chair Johnson and Monterey Railing Public Art Committee with Vice Chair Johnson, Chair Cahalen: Chair Cahalen  
Second: Vice Mayor Clarke

Motion to approve: 1) The Twilight Committee be composed of Commissioner Lengre, Commissioner Sylvan, Vice Chair Johnson and James Wallace as Public Member; 2) Plein Air Committee be assembled after event debrief and Committee roles established; 3) Establish a Volunteer Recruitment Committee composed of Vice Mayor Clarke and Chair Cahalen; 4) Discontinue the Banner Committee, Movie Committee and Art at the Beach Committee: Vice Mayor Clarke

Second: Chair Cahalen

Voting Yea: Chair Cahalen, Vice Mayor Clarke, Commissioner Hill, Commissioner Holmberg, Commissioner Lengre, Commissioner Sylvan, Vice Chair Johnson.

**c. Arts Council Santa Cruz County Liaison**

Report given by Staff. Vice Chair Johnson reported on his experience as Liaison. Commissioner Holmberg commented on his experience with the organization.

Public Comment:

Motion to approve the appointment of Commissioner Holmberg to serve as the Arts Council Santa Cruz County Liaison: Chair Cahalen

Second: Commissioner Hill

Voting Yea: Commissioner Cahalen, Vice Mayor Clarke, Vice Chair Hill, Commissioner Holmberg, Commissioner Lengre, Commissioner Sylvan, Chair Johnson

**d. Goal Setting Meeting for FY25/26**

Report given by Staff. The Commission discussed potential dates for the annual Art & Cultural Commission Special Meeting Retreat and preference for location to be at the City Hall Community Room. Feb 19 at 6pm perforce, community here, community center.

Public Comment:

Motion to approve scheduling the annual Art & Cultural Commission Special Meeting Retreat for February 19, 2025, at 6pm, location TBD: Chair Cahalen

Second: Commissioner Sylvan

Voting Yea: Commissioner Cahalen, Vice Mayor Clarke, Vice Chair Hill, Commissioner Holmberg, Commissioner Lengre, Commissioner Sylvan, Chair Johnson

**e. Begonia Festival Commemorative Public Art**

Report given by Staff. The Commission discussed the proposed Plaque Proof provided by Sean Monaghan. The Committee will visit the artist and view the work. Vice Mayor Clarke commented that the tree canopy and electrical boxes at the art site should be assessed. The Commission discussed requesting a Mayor's Proclamation to be given to Minna Hertel during the unveiling event that will be held on February 22, 2025.

Public Comment:

Motion to approve the Begonia Festival Commemorative Plaque for production:

Commissioner Hill

Second: Chair Cahalen

Voting Yea: Commissioner Cahalen, Vice Mayor Clarke, Vice Chair Hill, Commissioner Holmberg, Commissioner Lengre, Commissioner Sylvan, Chair Johnson.

**10. Future Agenda Items**

**a. Commissioner Training**

**b. Rispin Arts Grant: Letter of Support**

**11. Adjournment**

The meeting was adjourned at 8:31 PM to the next regular Art & Cultural Commission meeting on February 11, 2025.

ATTEST:

---

Nikki Bryant

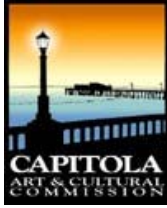

Item #: 7

# ART & CULTURAL COMMISSION

## Program & Committee Reports

FROM: Committee Chairs and Staff

DATE: January 30, 2025

SUBJECT: Report out for budgeted Art & Cultural programs.

**Recommended Action:** Receive report from committees or staff.

---

### **BACKGROUND**

The Capitola Art & Cultural Commission is an advisory body whose responsibility is to advise the City Council as to the allocation of public art funds and encouragement of existing and new programs in the arts for the enjoyment of the residents.

The Art & Cultural Commission participates in annual goal setting from which programs in the arts are planned for production in the budget year with City Council approval. The 2024/25 budget has planned twelve (12) Twilight Concerts, four (4) Art at the Beach, two (2) Movies at the Beach and Plein Air. Staff provide program reports on activity when relevant.

The Commission forms Committees for the support of City programs and, shall report to the Commission no less than quarterly under the Bylaws. Committees shall consist of no fewer than two (2) and no more than three (3) commissioners. If a vacancy occurs, the commission can choose to appoint a commissioner to the vacancy. The committees are as follows:

- 1) Twilight Concerts: Vice Chair Johnson, Commissioner Lengre, Commissioner Sylvan and Public Member James Wallace, sit on the committee.
- 2) Plein Air: Pending
- 3) Volunteer Recruitment: Chair Cahalen, Council Member Clarke sit on the committee.

### **DISCUSSION**

Regular reports from staff and committees are provided to enhance communication and planning as well as keeping the entire commission up to date on the progress made by staff or committees. Program Reports are intended to only report out on progress. Any action requiring the entire commission to make a decision will be added to a future agenda under General Business.

### **ATTACHMENT**

**Report Prepared By:** Nikki Bryant  
Community Services & Recreation Director

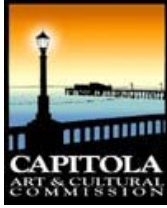

# ART & CULTURAL COMMISSION AGENDA REPORT

## MEETING OF February 11, 2025

FROM: Staff  
DATE: February 11, 2025  
SUBJECT: National Endowment for the Arts FY26 Grants

---

### **Recommended Action:**

Provide feedback to staff on the proposed application for the National Endowment for the Arts (NEA) FY26 Grants for Arts Projects (GAP) program. Staff is seeking input on a refined project scope focusing on the mosaic installation at the Rispin Mansion Fountain.

### **BACKGROUND**

In a previous grant cycle, staff submitted an application for the Arts in California Parks Grant Program to support multiple public art enhancements at the Park at Rispin Mansion. That application proposed a range of artistic interventions, including sculptures, murals, and mosaics, to highlight the site's historical and cultural significance.

For the current funding opportunity under the NEA's FY26 Grants for Arts Projects (GAP) program, staff proposes refining the scope of the prior grant application to focus specifically on the mosaic enhancement of the historic fountain at Rispin Mansion. The NEA's Visual Arts grants require a 1:1 funding match, and staff has identified this project as a strong candidate given its alignment with the program's objectives and existing funding considerations.

### **DISCUSSION**

The proposed Rispin Mansion Fountain Mosaic Project seeks to transform the existing 800-square-foot historic fountain into a vibrant, artist-designed mosaic, celebrating Capitola's heritage and natural environment. This scaled-down project will allow the City to pursue a high-impact, community-driven public art installation while meeting the grant's financial matching requirements.

#### Proposed Project Scope:

1. Mosaic Artwork: A professionally designed and installed mosaic surface for the fountain reflecting themes of Capitola's cultural and natural history.
2. Community Engagement: Public workshops to incorporate community input into the mosaic's design.
3. Historic Preservation: Art elements will be designed to complement the fountain's original structure while enhancing its aesthetic and interpretive value.
4. Accessibility Considerations: The project will incorporate ADA-compliant features, ensuring accessibility for all visitors.

#### Proposed Grant Costs:

- Mosaic Design & Installation: \$50,000 from grant
- Community Workshops & Outreach: \$11,000
- Project Management: \$10,000
- Grant Administration: \$9,000
- Interpretive Signage & Accessibility Features: \$5,000
- Other Public Works Construction Staff & Materials: \$15,000

Total Proposed Project Budget: \$100,000 (NEA Match Requirement: \$50,000 City Contribution)

Staff is requesting feedback from the Commission on the proposed project scope, community engagement strategies, and overall feasibility.

**FISCAL IMPACT** This project will require a 1:1 funding match, with \$50,000 proposed from City in kind staff time and resources. The project as proposed will not impact the Public Art Fund directly.

The NEA GAP grant allows for a request of up to \$100,000; however, any match beyond \$50,000 would need to come from other sources. The Commission may consider expanding the project scope if it wishes to allocate additional funds from the Public Art Fund for complementary artistic features.

The Public Art Fund has a current balance of \$95,850 and an estimated \$50,000 committed to current projects.

**ATTACHMENT**

1. Draft Project Description for NEA FY26 GAP Grant Application

**Report Prepared By:** Nikki Bryant  
Director of Community Services & Recreation



## Project Details Tab

### NEA DISCIPLINE FOR PROPOSED PROJECT\*

*Drop down, select: Visual Arts*

### PROJECT SYNOPSIS

To support the Rispin Mansion Fountain Mosaic Project, which will transform the existing 800 SF concrete fountain with a vibrant, artist-designed mosaic reflecting Capitola's history, nature, and community.

### PROJECT DESCRIPTION

#### **Project Description: Rispin Mansion Fountain Mosaic Project**

The Rispin Mansion Fountain Mosaic Project will transform the existing 800-square-foot historic concrete fountain into a stunning public artwork that celebrates Capitola's cultural heritage, natural beauty, and community identity. This project will replace the fountain's aged surface with a vibrant artist-designed mosaic, creating an interactive and visually engaging space that integrates art and nature.

Through a community-driven artist selection process, this initiative will ensure that the final design reflects the voices and visions of Capitola residents, fostering a sense of ownership and pride in public art. The Capitola Art and Cultural Commission will oversee the selection of a qualified artist or artist team to design and implement the mosaic, incorporating historical themes, regional landscapes, and environmental motifs inspired by Soquel Creek and the surrounding ecosystem.

---

### Project Activities & Timeline

#### **Phase 1: Artist Selection & Design Development (Months 1-5)**

- Issue a Call for Artists, encouraging submissions from local and regional artists with experience in large-scale mosaic installations.
- A selection committee, including members of the Capitola Art and Cultural Commission, city staff, and community representatives, will evaluate proposals based on artistic excellence, feasibility, and relevance to Capitola's history and landscape.
- The selected artist(s) will engage with community members through a public workshop to gather input and refine the mosaic concept.

#### **Phase 2: Community Engagement & Final Design Approval (Months 6-9)**

- The artist(s) will present preliminary designs in a public meeting, incorporating feedback from residents and local stakeholders.

- The final design will be reviewed and approved by the City of Capitola and Art and Cultural Commission.

### **Phase 3: Fabrication & Installation (Months 10-16)**

- **Surface preparation:** The fountain's existing concrete structure will be cleaned, leveled, and waterproofed.
- **Mosaic fabrication:** The artist will work in stages, creating detailed mosaic panels offsite or in a collaborative setting where the public can observe the process.
- **Installation:** The completed mosaic panels will be securely adhered to the fountain structure, followed by grouting and sealing for long-term durability.
- The city will coordinate with contractors for site logistics, ensuring minimal disruption to the park.

### **Phase 4: Public Dedication & Education (Month 17-18)**

- A community unveiling event will celebrate the project's completion, featuring discussions with the artist and interactive educational activities about public art and mosaic craftsmanship.
- The city will install interpretive signage detailing the artwork's themes, artist biography, and the significance of the Rispin Mansion and Soquel Creek to Capitola's history.

---

## **Artistic Excellence & Community Impact**

The Rispin Mansion Fountain Mosaic Project will elevate the park experience by blending historical storytelling with contemporary public art. The project's themes will draw from:

- The rich history of the Rispin Mansion as a landmark in Capitola.
- The ecological significance of Soquel Creek, incorporating imagery of native plants, wildlife, and water elements.
- The community's connection to the site, honoring Capitola's cultural evolution and its diverse residents.

This project will be publicly accessible year-round, welcoming visitors of all ages and backgrounds to experience the transformative power of art in outdoor spaces. By prioritizing local artist engagement, the project will contribute to Capitola's creative economy, providing direct compensation to artists and skilled craftspeople involved in fabrication and installation.

---

## **Budget & Project Feasibility**

This project is designed to be achievable within the available funding, ensuring high artistic quality while maintaining fiscal responsibility. The budget includes:

- \$50,000 in grant funding for artist fees, materials, fabrication, and installation.
- \$30,000 in city staff time for project oversight, logistics, and park maintenance coordination.
- \$20,000 in Local match contributions for additional material costs, community engagement activities, and interpretive signage.

The City of Capitola has extensive experience managing public art projects and will oversee all logistical and permitting requirements, ensuring timely project completion within a 9-month performance period.

---

### **Conclusion: Why This Project Matters**

The Rispin Mansion Fountain Mosaic Project will revitalize a historic public space, transforming it into a work of art that connects Capitola's past and present. By engaging the community in the creative process, this initiative will foster a deeper appreciation for public art, cultural storytelling, and environmental stewardship. The project aligns with the Arts in California Parks program's goals by creating a meaningful, inclusive, and visually captivating experience that will inspire generations of Capitola residents and visitors alike.

### **PROPOSED PROJECT START DATE/END DATE**

Start Date: 01/01/2026

End Date: 07/31/2027

### **SCHEDULE OF KEY PROJECT DATES**

#### **Phase 1: Artist Selection & Design (Jan - May 2026)**

- **January:** Issue Call for Artists
- **February:** Selection committee reviews proposals
- **March:** Artist selection and contract finalization
- **April:** Public workshop for community input
- **May:** Preliminary design presentation

#### **Phase 2: Community Engagement & Design Approval (Jun - Sep 2026)**

- **June - July:** Artists refine designs based on community feedback
- **August:** Final design approval by the City and Art Commission
- **September:** Materials procurement and preparation

### **Phase 3: Fabrication & Installation (Oct 2026 - Apr 2027)**

- **October - November:** Surface preparation (cleaning, waterproofing, leveling)
- **December - February:** Mosaic fabrication (offsite and publicly accessible workspace)
- **March - April:** Installation (affixing panels, grouting, sealing)

### **Phase 4: Public Dedication & Accessibility Enhancements (May - July 2027)**

- **May:** Community unveiling event and artist talk
- **June:** Interpretive signage installed
- **July:** Final documentation and project closeout

## **ENGAGEMENT WITH INTENDED COMMUNITY, PARTICIPANTS & AUDIENCE**

### **Engagement with Intended Community, Participants & Audience**

The Rispin Mansion Fountain Mosaic Project will engage a diverse range of community members, including local residents, artists, and visitors, fostering civic pride and cultural appreciation while ensuring accessibility and inclusion. The project will create opportunities for direct participation, allowing the public to contribute ideas, observe the mosaic's creation, and interact with the final installation.

### **Intended Communities & Audiences**

- **Local Residents:** Encouraged to participate in design workshops and public meetings to contribute ideas and cultural insights.
- **Artists & Artisans:** Opportunities for both established and emerging artists to contribute to a significant public artwork.
- **Tourists & Visitors:** The mosaic will contribute to Rispin Park as a landmark attraction, enhancing Capitola's cultural tourism appeal.
- **Historically Underserved Groups:** Outreach will include underrepresented communities, providing opportunities for active engagement in the public art process.

### **Engagement Strategies**

- **Public Workshops & Feedback Sessions:** Residents will have direct input on the artwork's design.
- **Collaborations with Local Organizations:** Partnerships with schools, community groups, and accessibility advocates.

- **Artist-Led Educational Programs:** Free demonstrations and discussions on the mosaic creation process.
- **Social Media & Public Promotion:** Updates and engagement through online platforms to reach a wider audience.

### Accessibility & Inclusion

- The mosaic and interpretive signage will be ADA-compliant, ensuring that all visitors can engage with the installation.
- Workshops and educational events will be held in physically accessible venues.
- The project will actively include people with disabilities as artists, collaborators, and audience members, ensuring non-exclusionary participation.

## PROJECT GOALS AND MONITORING

The project's goals include enhancing public art accessibility, fostering community engagement, and promoting local cultural heritage. Participants will experience hands-on artistic collaboration and cultural storytelling, strengthening their connection to public art.

### Monitoring and Evaluation

- **Attendance Tracking:** Document participation in workshops, public meetings, and unveiling events.
- **Community Feedback Surveys:** Gather input from residents and participants on engagement and impact.
- **Artist and Partner Evaluations:** Collect insights from collaborating artists and organizations.
- **Photo and Media Documentation:** Capture project progress and share learnings through public channels.
- **Post-Project Review:** Assess impact on public space use and community interaction with the completed mosaic.

Findings will be shared with local stakeholders, city officials, and the arts community, demonstrating the project's success and informing future public art initiatives.

## PROJECT PARTNERS & KEY INDIVIDUALS

1. **Partner Name:** Capitola Art and Cultural Commission
  - **Proposed or Committed:** Committed
  - **Type:** Government - Municipal
  - **Description:** The Capitola Art and Cultural Commission will oversee the artist selection process, ensuring alignment with community values and

historical significance. The commission's experience in managing public art projects ensures the installations are relevant and meaningful to Capitola's residents. Their involvement guarantees a fair and inclusive selection process, enhancing overall quality and acceptance.

2. **Partner Name:** Local Artists (Various)

- **Proposed or Committed:** Proposed
- **Type:** Individual
- **Description:** Local artists will design and fabricate the mosaic artwork for the Rispin Mansion Fountain. They will engage with the community through public workshops, incorporating local history and cultural themes into the design. By collaborating with residents, these artists will ensure the mosaic reflects Capitola's heritage and natural surroundings. Their participation will strengthen community connections to public art and create a lasting, site-specific installation.

3. **Partner Name:** Capitola Historical Museum

- **Proposed or Committed:** Committed
- **Type:** Organization - Other Non-profit
- **Description:** The Capitola Historical Museum will provide historical context and resources for the project, ensuring accuracy and depth in the historical representations within the art installations. Their expertise enhances the educational value of the project, transforming the park into a space where visitors can learn about Capitola's history through engaging and informative art.

4. **Partner Name:** City of Capitola Public Works and Community Services  
Departments

- **Proposed or Committed:** Committed
- **Type:** Government - Municipal
- **Description:** City staff from Public Works and Community Services will coordinate logistics, manage construction schedules, and oversee compliance with local regulations. Their expertise ensures that the project aligns with municipal goals for accessibility, safety, and sustainability while fostering strong community partnerships.



### Reflecting Pool – Sheet L-1.0

#### Tile Mosaic

Description: The bottom of the reflecting pool will feature a tile mosaic depicting elements of the natural environment.

Theme: This mosaic will promote environmental stewardship by showcasing local flora and fauna, as well as aquatic motifs.





THE PARK AT RISPIN MANSION  
Wharf Road and Clares Street  
Capitola, California

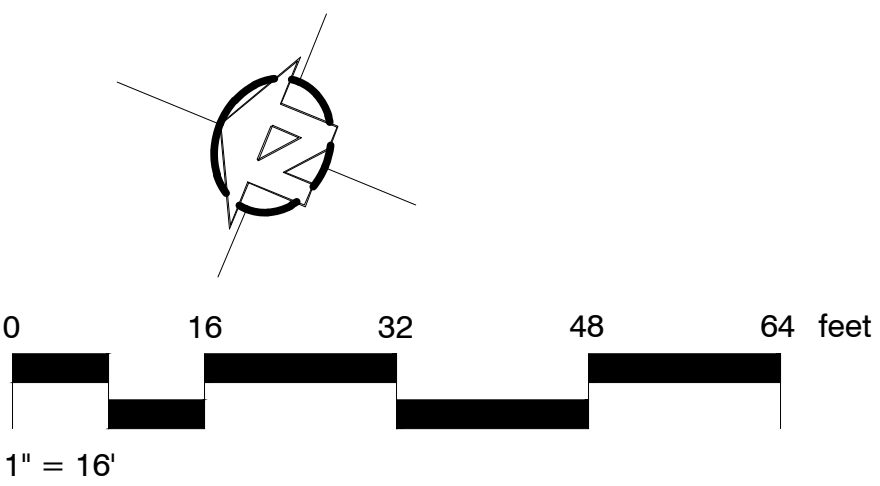
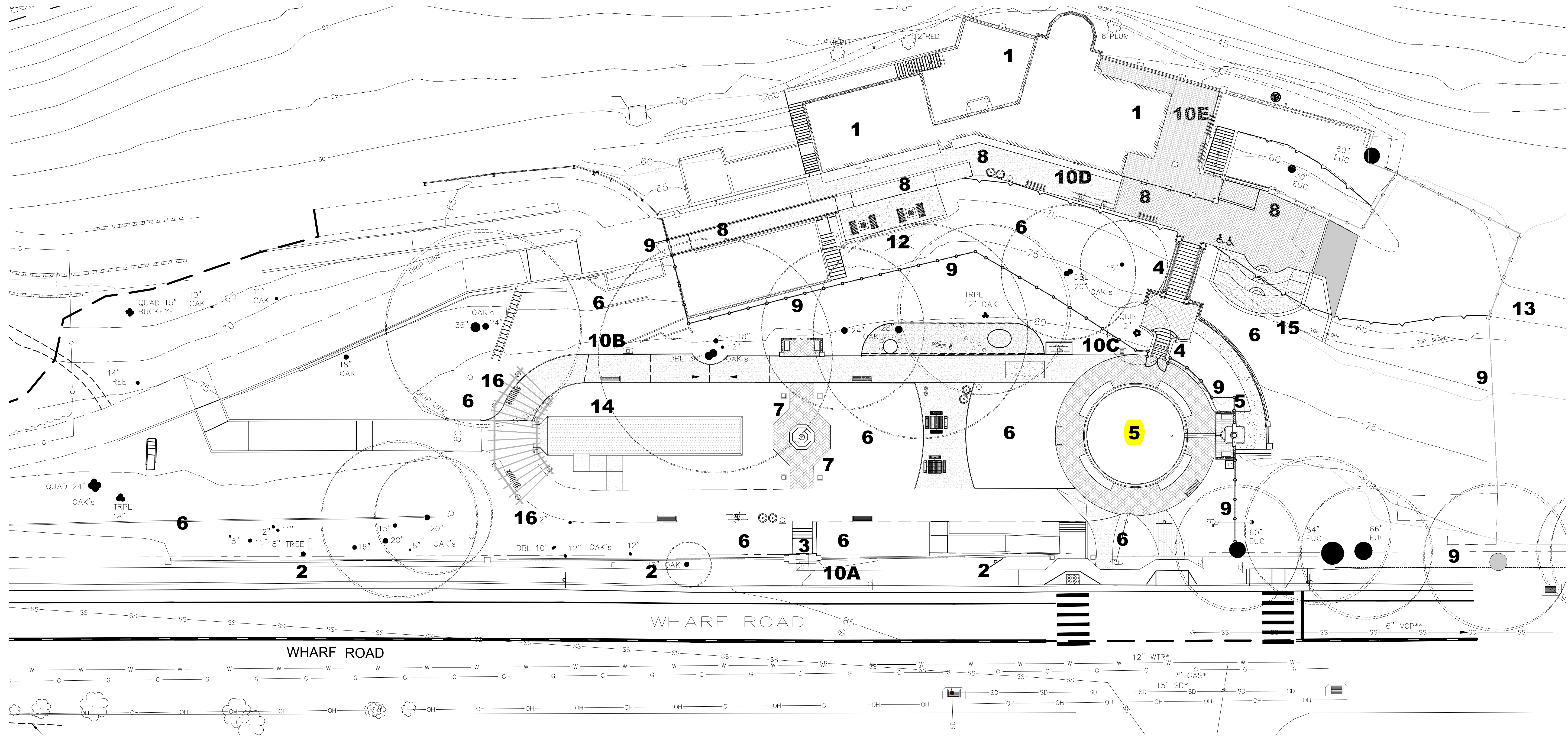

- EXISTING FEATURES AND PROPOSED AMENITIES**  
(N) denotes new element  
(H) denotes existing element found on site
1. RISPIN MANSION BUILDING (H)
  2. WHARF ROAD WALL (H)
  3. WHARF ROAD ENTRY STEPS (H)
  4. GRAND STAIRCASE AND BALUSTRADE (H)
  5. FOUNTAIN AND REFLECTION POOL (H)
  6. PLANTS AND LANDSCAPE (N)
  7. SUNDIAL (H) AND SCULPTURE GARDEN (N)
  8. UNIVERSAL ACCESS PATH OF TRAVEL (N)
  9. FENCING AND GATES (N)
  10. SIGNAGE (N)
  11. IMPROVE STRIPING AND CROSSWALKS AT CLARES/WHARF ROAD INTERSECTION (N)
  12. MURAL ON CONCRETE WALL OF SAINT CLARES BUILDING (N)
  13. INFORMAL SERVICE DRIVE/PEDESTRIAN PATH FROM MANSION TERRACE TO SOUTH ENTRANCE AT WHARF ROAD (H)
  14. BOCCIE BALL COURT (N)
  15. AMPHITHEATER (N)
  16. ARBOR (H)

**Summary of Historic Elements found on Rispin Site and Proposed Renovations**

**Discussion of Intent.**  
The project goals for Rispin Park are to create a community park that provides passive recreation and focuses on the cultural, historical, and open space resources that are unique to the Rispin Mansion Site. The intent of the restoration is to provide examples of the architectural style of the mansion and to create a public awareness of the significance of the Mansion building and grounds as part of the history of the City of Capitola. It should be stated that the park is not intended to be an exact replication of the mansion grounds during the time it was the residence of Henry Rispin. A summary of the existing historic elements and the proposed modifications are explained below and noted on the Site Plan.

**Wharf Road Wall, Entry Arch and Entry Staircase:**

- Portions of the Existing wall along Wharf Road will remain unchanged, while some sections of the existing wall height will be reduced to 30' with a 30" decorative metal fence on top. One portion of the wall at the southern end of the road frontage will be removed to allow a new universally accessible entrance to the park. The section to be removed will incorporate a new column to match the existing last column at the southern terminus of the wall. Bollards and metal fencing will be added to the new park entrance.
- Steps and side walls of the staircase at the entry will be rebuilt and repaired. The Arch and side walls will be painted to match the Mansion.
- Existing wood gate to be removed and stored for display with other artifacts

**Arbor:**

- New columns will match historic columns found on site in height and architectural detail.
- Spacing of columns and location will be changed to accommodate new universally accessible path, and mature oaks on site.
- New vine species compatible with native oaks will be selected.

**Sundial:**

- Existing sundial base will remain in its present location. Pedestal will be rebuilt according to archive photographs. New, contemporary sundial/compass will be chosen, no archive photos are available that show the sundial piece.

**Overlook:**

- Existing overlook columns and base wall to remain. All caps and balustrades to be rebuilt according to archive photographs and existing artifacts on-site.
- New benches in same location as historical shown in archive photographs, architectural details not discernable in photos. New benches will be simple without ornamentation.

**Reflecting Pool:**

- Existing location and size of pool will remain unchanged. Depth of pool will be reduced to maximum of 6 inches. Repairs will be made to coping, pool sides and bottom. Plumbing and bottom of pool will be retrofitted to incorporate rainwater harvesting system.
- Brick path around pool will be installed, consistent with archive photos.
- New sculpture in center of pool will replace water feature(s) shown in archive photos. New sculpture will be distinctly different in style than those of the Rispin period.
- A tile mosaic is proposed for the bottom of the fountain. Mosaic will be commissioned by Capitola Arts Commission.

**Wall Fountain and Lower Sitting Area behind Wall Fountain:**

- Existing fountain will be repaired to working condition. Missing parts will be reconstructed using archive photographs and site artifacts.
- Urn will be selected to match historic using archive photographs.
- New fountain spout will be selected, historical fountain spout style not discernable in photos. New fountain spout will be simple without ornamentation.
- Lower seating area behind fountain and balustrade wall from grand staircase will be repaired according to archive photographs and existing artifacts on-site. Pathway from brick landing to seating area will be rebuilt.

**Grand Staircase:**

- All walls, columns, column caps, brick landings, to be repaired according to archive photographs and existing artifacts on-site. Steps to be rebuilt.
- A new metal handrail as per code will be added on each side, mounted in ground outside of cheek wall.

**Miscellaneous Garden Features**

- 12" high concrete wall along old walkway at northwest corner of park to remain.
- Rock fossil walls by staircase to remain.
- Stone wall at north end of park by new ramp to remain.
- Existing 18" wide red concrete steps north of arbor to remain; add handrail as per code
- Existing 4' wide concrete steps by Game Table area to remain; add chain barricade and sign to close off

© Michael Arnone Landscape Architect - 2023

THESE DRAWINGS ARE INSTRUMENTS OF SERVICE, ISSUED FOR ONE TIME SINGLE USE BY THE OWNER. THE ENTIRE CONTENTS OF THESE DRAWINGS IS COPYRIGHT © MICHAEL ARNONE LANDSCAPE ARCHITECT. LANDSCAPE ARCHITECT RETAINS ALL RIGHTS AND TITLE. NO PART MAY BE REPRODUCED IN ANY MANNER OR BY ANY MEANS WITHOUT THE EXPRESS WRITTEN APPROVAL OF THE LANDSCAPE ARCHITECT. THE PROPER ELECTRONIC TRANSFER OF DATA SHALL BE THE USER'S RESPONSIBILITY WITHOUT LIABILITY TO THE LANDSCAPE ARCHITECT.

OWNER SHALL ASSUME RESPONSIBILITY FOR COMPLIANCE WITH ALL EXISTING, SETBACK, REQUIREMENTS AND PROPERTY LINES. OWNER SHALL ACQUIRE ALL NECESSARY PERMITS REQUIRED TO PERFORM WORK SHOWN ON PLANS. BASIS INFORMATION HAS BEEN PROVIDED BY THE OWNER. MICHAEL ARNONE LANDSCAPE ARCHITECTURE ASSUMES NO LIABILITY FOR THE ACCURACY OF SAID PROPERTY LINE BOUNDARIES, FENCE LINES OR PROPERTY CORNERS.

REVISIONS

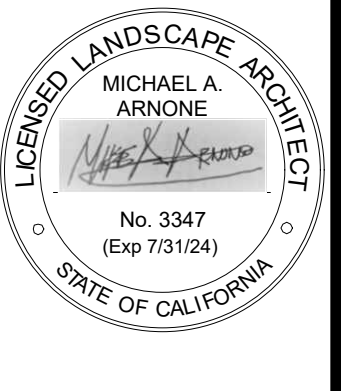

SITE PLAN & PHASING PLAN

JOB NO. 201503  
SCALE 1/16" = 1' - 0"  
DRAWN MA  
CHECK JC/MA  
DATE 2.22.2023

SHEET  
L- 1.0

SHEET 2 OF 20



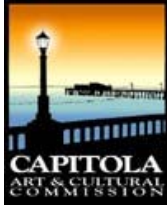

Item #: 9.c

# ART & CULTURAL COMMISSION AGENDA REPORT

## MEETING OF February 11, 2025

FROM: Staff  
DATE: February 4, 2025  
SUBJECT: Begonia Festival Commemorative Public Art Project; Dedication

---

**Recommended Action:** Provide final feedback for Begonia Festival Commemorative Public Art Dedication Event

---

### **BACKGROUND**

In the 1950s, Capitola was recognized as the “World Begonia Capital”. The City hosted the well-known Begonia Festival, which ran from the 1950s through 2017. The last Begonia Festival was held in 2017, due to the closure of local begonia fields. In April 2018, Board Members of the Capitola Begonia Festival contacted the Art and Cultural Commission regarding the proposal of a public art project commemorating the Begonia Festival. The Begonia Festival Board (currently known as the Capitola Beach Festival) voted to donate \$20,000 to the City to be used toward a commemorative public art piece.

In March 2023, staff published a Call to Artists and received eleven (11) submissions. The Art and Cultural Commission appointed a subcommittee to review artist submissions and select three submissions for the Art and Cultural Commission to review and make a final selection. On April 9, 2024, the Commission selected the concept presented by Geoffrey Nelson and on September 26, 2024, the City Council authorized the City Manager to enter into an agreement with Geoffrey Nelson.

### **DISCUSSION**

The current timeline for installation is February 11, 2025. The contributing organizations desire a dedication event to complete the project. The event is scheduled to be held February 22, 2025, from 3ppm to 5pm. The Begonia Public Art Project Committee worked with staff to plan the event.

**FISCAL IMPACT** None

### **ATTACHMENT**

**Report Prepared By:** Nikki Bryant  
Director of Community Services & Recreation